

PRESENTED:
CAVITIES OPEN
Darstellung:
Kammern offen

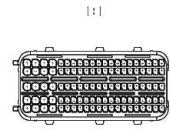

BETWEEN THE CAVITIES MATERIAL RECESSES PERMITTED
Materialaussparungen zwischen den Kammern zulässig

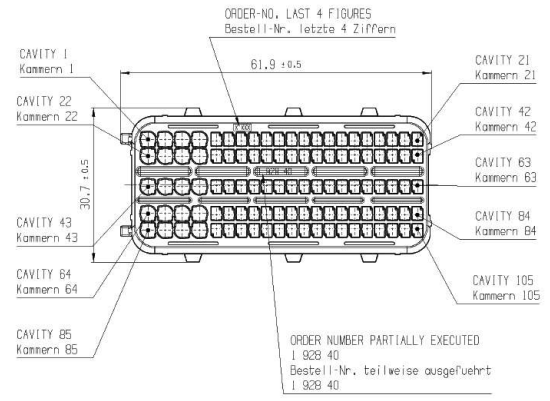
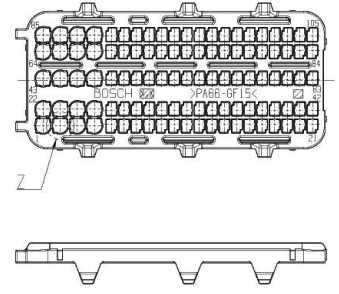
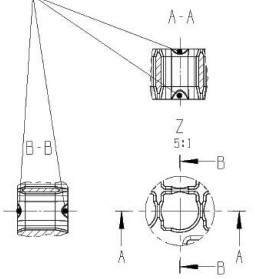

PRESENTED (EXAMPLE):
MINOR VARIANTS OF ASSEMBLING
Darstellung (Beispiel):
Variante fuer Minderbestueckung

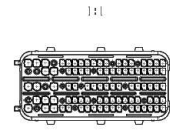

VERSION 1
FOR WIRE SIZE RANGE
1,0-1,5mm² FLR-WIRE (MAX. 20x)
Ausfuehrung 1
P: Leitungsquerschnitt
1,0-1,5mm² FLR-Leitung (max. 20x)

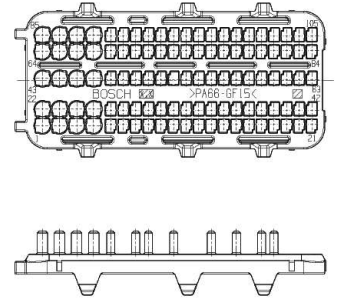
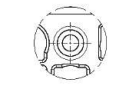

VERSION 2
FOR WIRE SIZE RANGE
0,35-0,75mm² FLR-WIRE (MAX. 85x)
Ausfuehrung 2
P: Leitungsquerschnitt
0,35-0,75mm² FLR-Leitung (max. 85x)

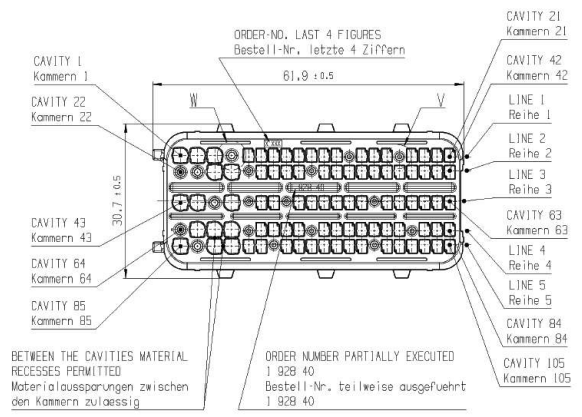

MINIMUM ORDER QUANTITY: 1 PACKAGE
Minderbestellmenge: 1 Packeinheit

FOR REDUCTION OF THE NUMBER OF VARIANTS ADDITIONAL
UPTO 6 BLIND TERMINALS HAVE TO BE USED
(IN CASE OF EXCEEDING: NEW VERSION OF HOLDING PLATE)
Zur Verringerung der Variantenzahl sind zusaetzlich
bis zu 6 Dichtstifte einzusetzen
bei Ueberschreitung: neue Halbleiterversion!

ITEM Pos.	DESIGNATION Benennung	ORDER No. Bestell-Nr.	MATERIAL Stoff	COLOR Colour Farbe	REMARKS Bemerkungen
I	HOLDING PLATE Halbleitplatte	SEE TAB./s. Tab.	PA 66 - GF 15	BLACK schwarz	

PARTS MAY BE DIFFER IN NON-FUNCTIONAL
DETAILS FROM THE REPRESENTATION IN THIS DRAWING
Teile koennen in nicht funktionsrelevanten Details
von der Darstellung in dieser Zeichnung abweichen

Part No.	Designation	Order No.	Material	Color	Remarks
271 F1928406338	HALBLEITPLATTE	20180507	PA66 GF15	schwarz	
281 F1928406303	HALBLEITPLATTE	20170509	PA66 GF15	schwarz	
291 F1928406327	HALBLEITPLATTE	20170519	PA66 GF15	schwarz	
301 NEW DESIGN	HALBLEITPLATTE	20180514	PA66 GF15	schwarz	

General tolerance for all dimensions unless otherwise specified	in mm
±0,5mm	±0,5mm
±0,2mm	±0,2mm
±0,1mm	±0,1mm

Part No.	Designation	Order No.	Material	Color	Remarks
1 928 A00 479	HALBLEITPLATTE	20180507	PA66 GF15	schwarz	

